



The versatile smart MFP delivering seamless integration for your document workflow

PRINT COPY SCAN FAX NETWORK



- | | |
|---|---|
| A3/A4 | ✓ |
| Colour/Mono | ✓ |
| Duplex print, copy, scan, fax | ✓ |
| Prints A6 to 210 x 1321mm, up to 256gsm | ✓ |
| 1 – 30+ users | ✓ |



**3 YR
WARRANTY**



The ES8473 MFP offers the choice and flexibility to suit differing needs

Including:

- dn** duplex and networked
- dnct** duplex, networked, 2nd paper tray and cabinet
- dnx** duplex, networked, 2nd & 3rd paper tray and caster base
- dnv** duplex, networked, 2nd, 3rd & 4th paper tray and caster base



Versatile A3 colour smart MFP offering outstanding performance, quality and seamless integration into document workflow

Combining the reliability of OKI's award winning digital LED print technology with extensive copier functionality, in one high speed, easy to use device, the ES8473 MFP ensures outstanding print and copy quality as well as comprehensive scan and document management functionality.

OKI's smart Extendable Platform (sXP) ensures the ES8473 MFP sits at the heart of your document workflows with a very easy to use, customisable 7" touch screen to operate the device and manage all document functions.

High volume printing and copying are handled comfortably by the ES8473 MFP with speeds of up to 35ppm and over 2,000 sheet maximum paper capacity from 5 separate trays. Two output bins ensure jobs can be sorted on the go and built in stapling across the range make document creation convenient for all users in the workgroup. For extra peace of mind, OKI offers a unique 3 year warranty at no extra cost, simply register your product within 30 days of purchase^.

The ES8473 MFP brings outstanding value and performance to demanding workgroups without compromise.

ES8473 MFP

Faster print and copy speeds and higher capacity consumables make the ES8473 MFP the ideal solution for the most demanding workgroups. With print speeds of up to 35ppm and just 9.5 seconds to the first page out time in colour and mono, larger workgroups can use the ES8473 MFP with ease. Low user intervention and lower total cost of ownership, together with the easy to use operator panel ensure the whole workgroup is more productive and efficient.



ES8473 MFP features at a glance

	ES8473dn	ES8473dnct	ES8473dnx	ES8473dnv
Configuration	Duplex, networked	Duplex, networked, 2nd tray, cabinet	Duplex, networked, 2nd & 3rd tray, caster base	Duplex, networked, 2nd, 3rd & 4th tray, caster base
Print speed	A4: 35ppm colour/mono A3: 20ppm colour/mono			
Time to 1st Print	9.5 seconds			
Time to 1st Copy	10 seconds			
Paper capacity	400	935	1,470	2,005

Outstanding features to support your day-to-day print, copy, scan and fax requirements

Automatic duplex printing, copying, scanning and faxing as standard

Reverse Automatic Document Feeder (RADF) for simple, efficient and cost effective handling of multi-page, single and double sided documents.



Convenience stapler
Built-in convenience stapler as standard, for easy post production finishing.



Cost saving, high capacity toners

High capacity toner cartridges reduce total cost of ownership and user intervention.



User friendly and easy to operate

Customisable 7" colour LCD touch screen, intuitive menu system and enhanced help functionality; place frequently used functions on the home screen for quick and easy access.



Perfect for high volume print jobs

With a paper capacity of up to 2,005 sheets*, you can support your high volume print requirements in-house.



Flexible media handling
Print on a wide range of media sizes and weights, from A6 to 1.3m long banners and up to 256gsm, with the auto-sensing 100 sheet multi-purpose paper feed tray (MPT).



*ES8473dnv

Functionality to improve your productivity and workflow

With user friendly and intuitive displays, the ES8473 MFP offers outstanding print quality with the added functionality of copy, scan and fax. Efficiency and security are built in, with features including IPsec, Encrypted Secure Print, and authentications.

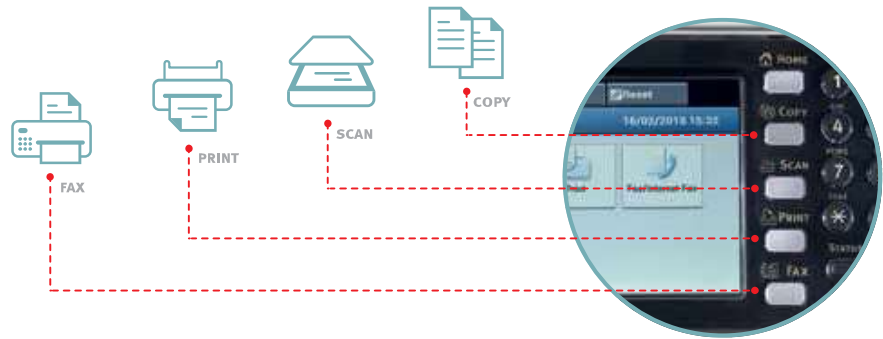

Print

Delivering exceptional colour at impressive speeds.

- High resolution colour and mono printing for professional business documents
- Colour and mono print speeds of up to 35ppm and 9.5 seconds to first print - perfect for time critical print jobs
- Duplex printing as standard - reducing paper consumption and enabling the production of business documents in-house
- Ultra-reliable digital LED print technology
- Encrypted Secure Print function for protected printing to ensure document confidentiality
- Paper capacity of up to 2,005 sheets, keeping user intervention to a minimum
- Auto sensing multi-purpose tray for printing on a wide variety of media sizes and weights

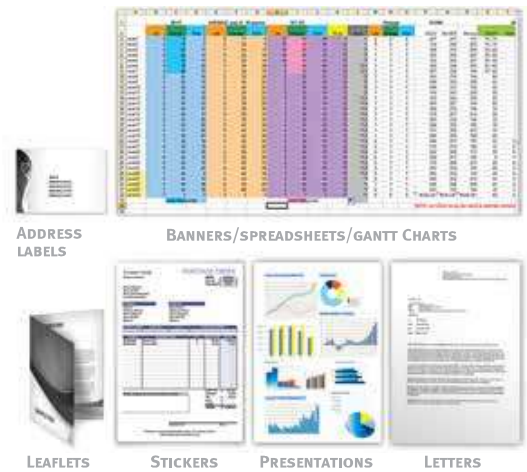

Fax

Enhanced fax functionality with Super G3 speed for efficient document management.

- Super G3 speed enables faxes to be sent and received at high speed
- Fax documents directly from or to your PC
- Forward faxes to another fax machine, network folder or directly to an email address
- Edge removal automatically cleans up images
- Block junk faxes to reduce printing costs
- Store and view incoming faxes on 7" display prior to printing to save paper
- Save time with up to 40 one-touch buttons and 1,000 speed dials to retrieve regularly used numbers

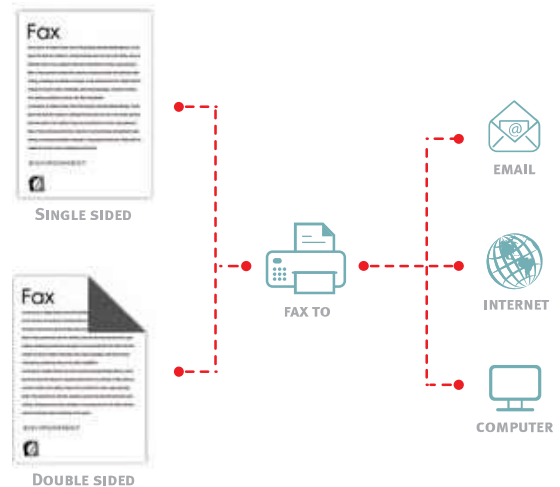

Automatic duplex printing, copying, scanning and faxing

All models include a 100 sheet Reverse Automatic Document Feeder (RADF) as standard for quick and easy copying, scanning, and faxing of double sided documents.



Scan

High Definition LED colour scanner improves document workflow.

- Fast scan speed of up to 50ipm
- 100 sheet RADF makes light work of multi-page, single and double sided documents
- USB and network TWAIN scanning (PC and Mac)
- Save scan settings for repeated tasks
- LDAP provides direct access to contact and email data from an existing directory server, saving time and improving the reliability of document delivery
- Job Build function enables a number of different documents to be scanned to create one single document output
- Scan directly to: USB, Network folder, email, FTP server, Local PC and Remote scan for fast and versatile document storage and management
- Scan preview for: email, shared folder, USB
- Blank page removal function - skips blank pages when scanning

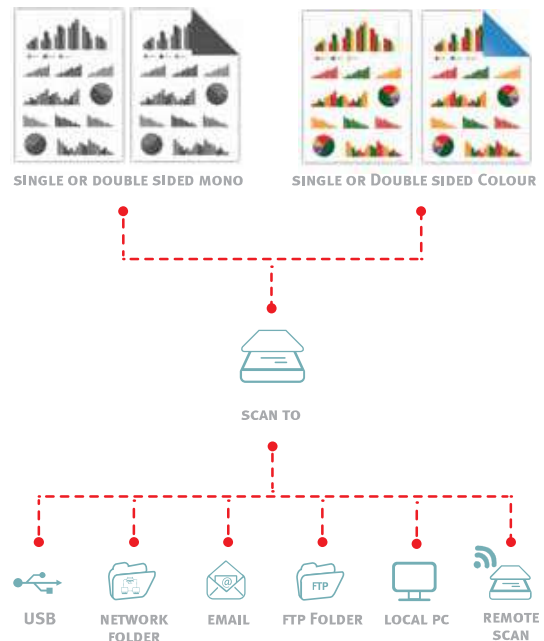

Copy

LED scanning and printing delivering superior copy quality for clear, accurate, and fast results.

- Multi-page documents, single or double sided, are handled with ease
- Fast, high quality copy output of up to 35cpm
- Job Macro function enables the user to programme frequently used copy settings
- ID Card copy for simple copying of double sided ID cards on a single sheet
- Background removal allows user to eliminate artefacts copied from glass or media on printed output
- Document collation automatically sorts copies of multi-page documents, saving you time
- Blank page removal function - skips blank pages when copying



Improving efficiency and reducing environmental impact

One of the most environmentally conscious A3 colour MFPs on the market, the ES8473 MFP consolidates multiple features into one efficient device, helping your business reduce its energy consumption, impact on the environment, and ongoing costs.



Consolidating multiple devices into one

Bringing together several devices into one efficient device reduces:

- Energy usage – saving you money and the environment
- Consumables consumption

Reducing power consumption

- 100% based on LED technology that inherently consumes less energy
- **Deep Sleep Mode** – reduces energy consumption to less than 3W

Duplex printing, copying and faxing as standard

- Reduces paper usage
- Enables printing professional documents in-house

Reducing toner usage

- **Toner Save function** – reduces the amount of toner used when printing draft or internal documents



Printing whilst on the move with mobile printing

OKI brings mobile printing to the workplace through innovation and technology. Many of our products, including the ES8473 MFP, are now compatible with mobile printing applications allowing you to print directly from your mobile device over wireless networks.

The ES8473 MFP is Google Cloud Print Ready, as well as being compatible with AirPrint by Apple Inc, enabling remote printing without having to connect directly to a printing device.



OKI provides a suite of software, available to OKI smart MFP customers at no additional cost

smartPrintSuperVision (sPSV)



For the management and control of networked printers and MFPs

With a powerful reporting structure, sPSV allows IT managers to manage devices and troubleshoot any problems without user intervention, providing complete control and visibility of all printers, regardless of make or model, across your network.

Provides visibility and control of your organisation's print spend

Gain visibility and control of print usage within your organisation, allowing you to restrict access to individuals or groups and manage printing and copying within defined cost limits. sPSV also provides you the ability to report on usage across the network, capturing information on volume, paper size, media type and consumables usage.

ABBYY FineReader Sprint

ABBYY ABBYY FineReader® helps you create editable, searchable files from paper documents, PDF files or digital photos, saving time as well as the hassle of retyping documents.

- Edit a scanned document or an image PDF and create new documents into editable files without the need of re-formatting the structure, tables, columns, font styles and sizes within your documents.
- Search and archive documents for quick and convenient retrieval, by converting them into searchable PDF and PDF/A formats.
- Convert documents into mobile-friendly formats, perfect for use with e-Book readers, tablets or smartphones.

SENDYS Explorer LITE



SENDYS Explorer enables the user to convert documents and distribute or upload to a chosen location, providing greater flexibility to edit, access, print, retrieve and share files.

- Document capture: From MFP, smartphone/tablet, desktop web interface and email.
- Document conversion: Transform scanned documents into a wide range of editable formats
- Document hub: Distribute scanned files.
- Print: Any document scanned or retrieved from the cloud directly from the MFP panel, smartphone/tablet or web interface.

sXP (smart Extendable Platform) at the heart of your business productivity

The ES8473 MFP comes with sXP, an open platform to help streamline your document intensive business processes.

This web services based platform enables seamless integration of these smart MFPs with your bespoke system or 3rd party solutions, for example, SENDYS Explorer, SENDYS Output Manager and PaperCut MF. This ensures that your document capture, distribution, management and output is efficiently executed and implemented, improving the productivity of your staff.

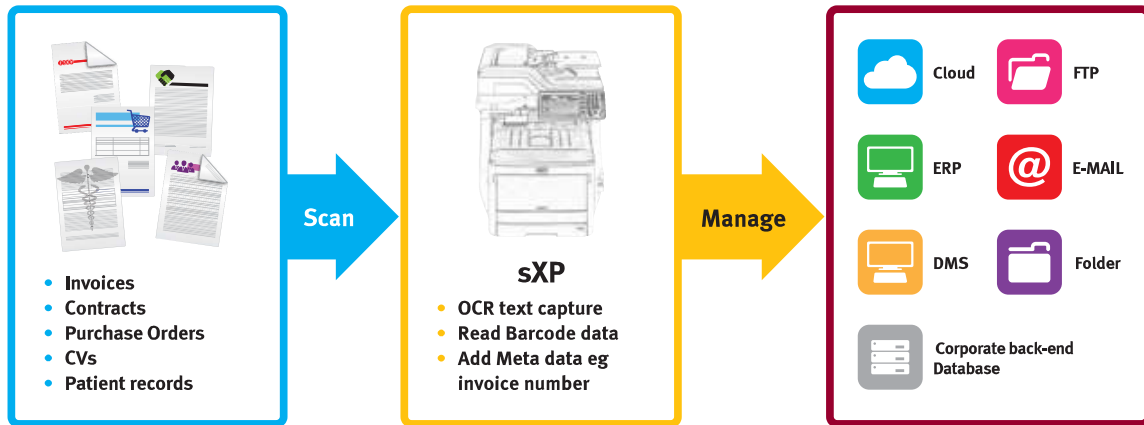

Smart Document Workflow

Bringing ease of use to your fingertips

Usability of the ES8473 MFP is further improved with a user-friendly 7" colour LCD touch screen display.

QWERTY keyboard to simplify data and email address entry

Job Macro function allows users to record and re-use key sequences to speed up frequently used operations

Dedicated function buttons take you quickly and directly to the desired mode of operation

Store and view incoming faxes prior to printing to save paper

Enhanced help function for handy, on screen graphic and text explanations



Customise your home screen to put frequently used functions at your fingertips for fast efficient working

Ergonomic design enables users to see screen content even when the MFP's lid is lifted.

Troubleshooting and diagnostic guidance

When it's time to replace user-replaceable consumables and maintenance items (toner cartridges, image drums, belt units and fuser units), the touchscreen display will alert you and walk you through the exact steps—and get you up and running in no time. The ES8473 MFP's firmware includes complete instructions on how to maintain important areas of the MFP, including paper feeds, the LED printheads, and the scanner unit.

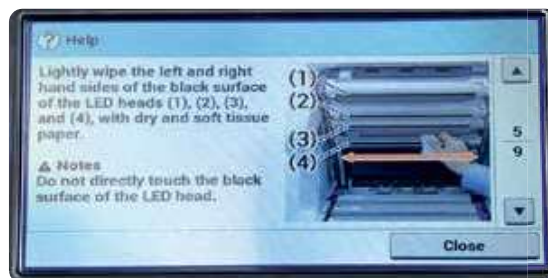

Business Printing Specialists

OKI's printer division is a global business-to-business brand dedicated to creating cost effective, professional in-house printing solutions which are designed to increase the efficiency of today's and tomorrow's businesses and their workflows. As pioneers in innovative print technologies from digital LED to High Definition Colour, we have a portfolio of award winning products and solutions enabling businesses to achieve both image focused, vibrant, quality print communications and budget flexibility.

OKI presents a full range of A3 and A4 colour and mono printers and MFPs, for workgroups and businesses of all sizes with superior media-handling capabilities. In addition our fax, POS and dot matrix printers complete our range of print solutions. These best-in-class products are designed to be easy to use making the job of in-house print easier.

WHY EXECUTIVE SERIES?

Building on OKI's heritage of award winning products, the exclusive Executive Series range of Multifunction Products, colour and mono printers provide hassle-free document solutions, budgetary control and enhanced workflow efficiency.

Our selected Executive Series partners can provide a print strategy and tailored solution that delivers total peace of mind through fully serviced products and the benefits of predictable budgeting.



Considering the Environment

As part of the OKI Group's Charter of Corporate Conduct, OKI continually reviews its efforts to provide environmentally sound solutions to its customers:

- Our products are designed and manufactured with reducing the impact on the environment in mind.
- Increasing the amount of our hardware products and consumables that are recycled is one of our strategic objectives.
- We feel responsible for conducting our business in an environmentally sound manner, contributing to conservation and activities within our local communities.

OKI's Green Leaf symbol, found on all products and packaging, represents our total commitment to collection, recycling and environmental processes.



High Definition Color

High Definition Color is OKI's own unique set of market defining hardware and software technologies. Together, these components deliver unsurpassed colour printing simply, intelligently, and with perfect results.



3 Year On-site Warranty[^]

[^]Our devices are manufactured to the highest standards of quality and technology, which has been confirmed by independent tests. We are so convinced of the high quality of our products that we are offering you an extension of the standard warranty period to 3 years at no extra cost to you. Simply register your product within 30 days of purchase to be eligible for our unique all inclusive offer. Fully covered by OKI! For further information please visit: <http://warranty.oki.com.au> (Australia) or <http://warranty.oki.co.nz> (New Zealand). Without registration, the standard 1 year warranty applies.



20 years of LED Technology

OKI pioneered the development of digital LED technology in printers over 20 years ago. This innovation delivers High Definition printing – for more accurate, striking printed documents. Thanks to this digital LED technology, our printers are compact, environmentally friendly and energy efficient, using significantly less raw materials in the manufacturing process and consuming less energy. LED print heads have no moving parts, making our LED printers robust and ultra reliable.



1 Ferngrove Place Chester Hill
NSW 2162, Australia
Tel: +612 9743 9214
www.tonermasters.com.au

OKI

Open up your dreams